

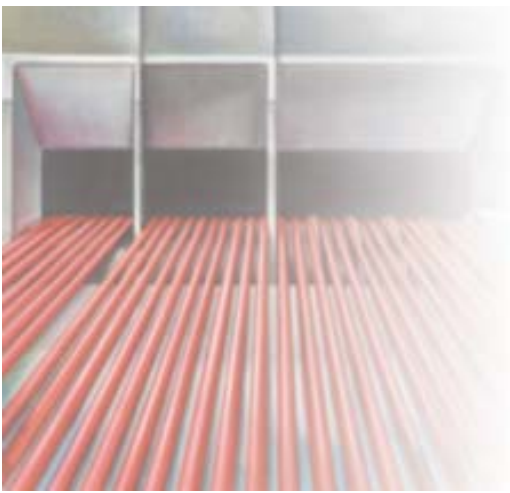

SGS-50E - SGS-200EL

Strandpelletizers Series SGS-E and SGS-EL



The several hundred SGS-E pelletizers already in continuous use are proof of quality and cost effectiveness of these machines. The entire range of thermoplastics is pelletized, from soft rubber-like to brittle, fragile, high-density and glass-fiber reinforced thermoplastics. The machines are designed for extreme working conditions in 3-shift operation and have an appropriate robust construction. The ideal balance between price and performance has always been our prime object.



SGS-50EL



SGS 50-EL shown with opened noise cover



SGS 50-E shown with classifier

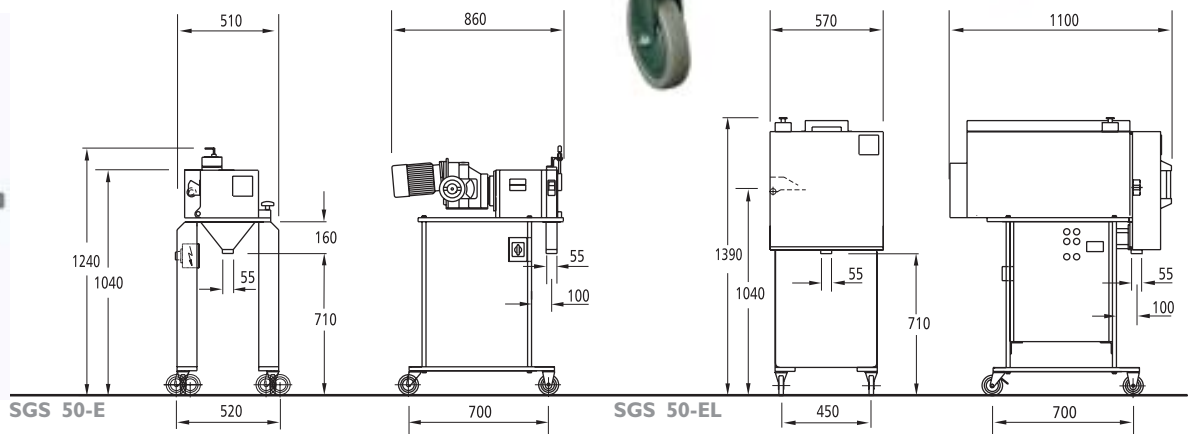



- Positive strand feed to pelletizer
- Optimum strand control due to partial strand wrap around the lower feed roll
- The pelletizer housing can be opened without tools for easy cleaning
- Rotor, upper and lower feed roll can be changed simply and quickly
- Drive and bearings are maintenance-free
- Rotor and bed knife of models SGS 100-E and SGS 200-E are interchangeable over the entire pelletizer range

SGS 200-EL with opened pelletizer housing



SGS 200-EL with opened noise cover

The standard machines are supplied ready for operation (including the electrical installation). The pelletizers can be adapted to the user's requirements. Additional equipment as die head, cooling bath, strand dewatering unit or classifier complete our range of supply.

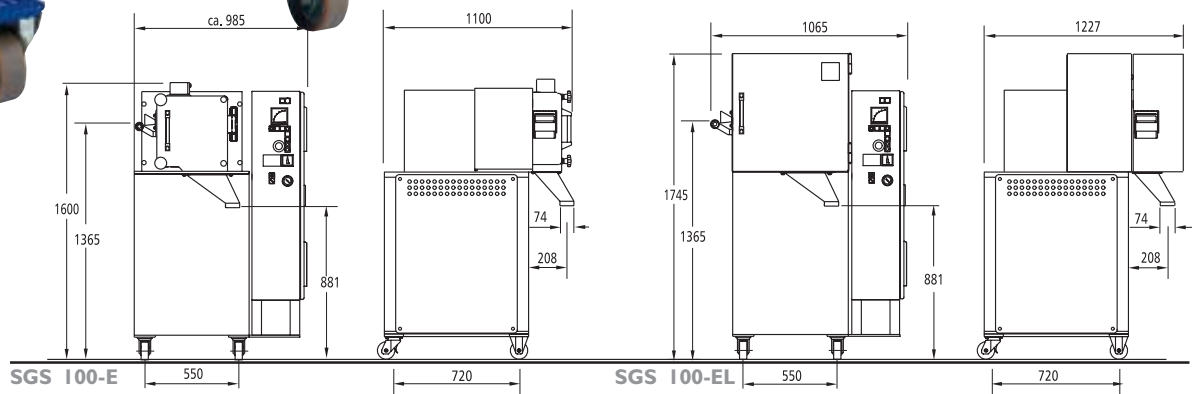

SGS-100E / SGS-100EL und SGS-200E / SGS-200EL

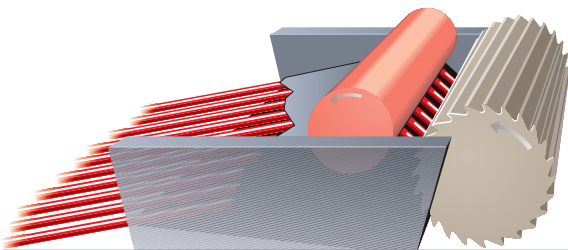

Positive strand feed to cutter

All strands entering the pelletizer are contained by side guides, so that once inside the intake chute they cannot escape from being cut.

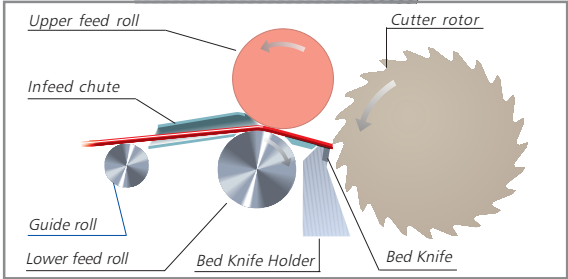

Strand feed and cutting arrangement

The guide roll, intake chute and the feed rollers are designed in a way that the strands partially wind around the lower feed roller. This arrangement achieves a high pulling force on the strands and therefore is ideal for strand intake conditions at low pressure loading of the upper feed roller, irrespective of variations in strand diameters. This feature increases the lifetime of the rubber coated upper feed roll substantially.

Perfected technical details

A particular improvement is the exchangeable intake chute available for models SGS 100-E and SGS 200-E (optional).

Easy cleaning and shortest change-over-time are the advantages of this feature.

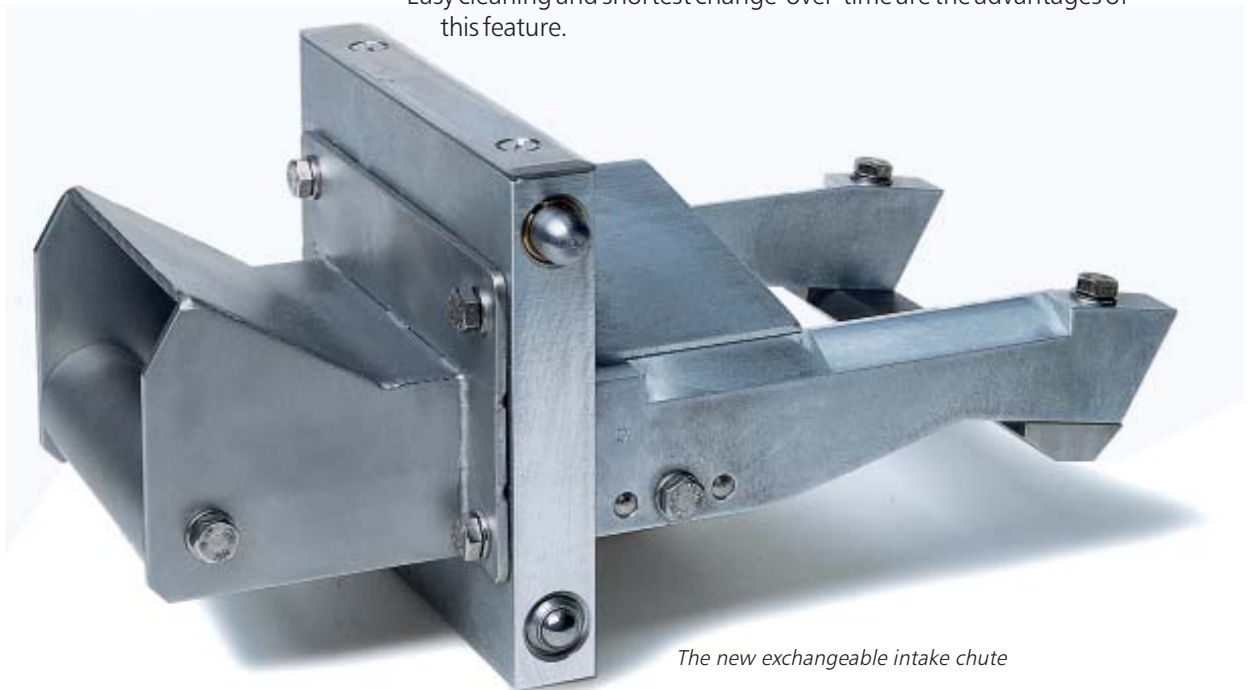

The new exchangeable intake chute



The infeed chute can be changed without using any tools

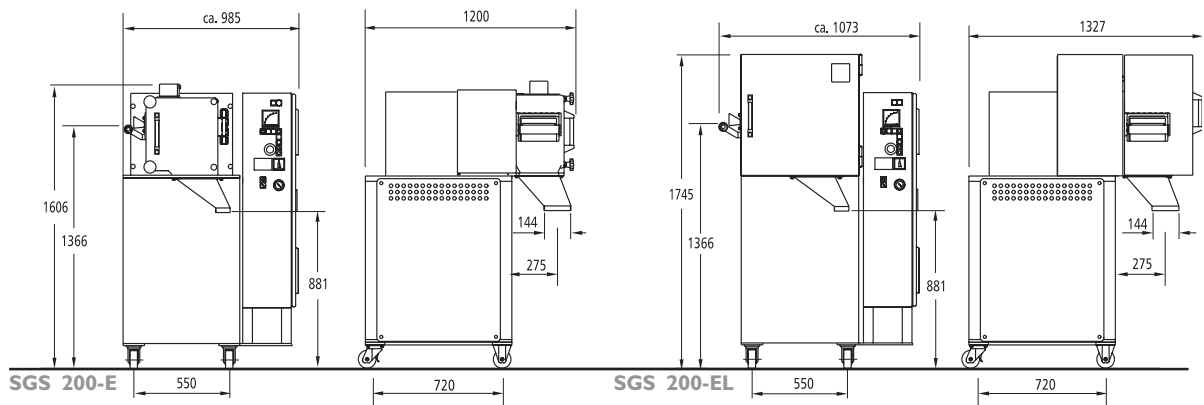

Technical Data



Strandpelletizer SGS 50-E

| | | | |
|----------------------------------|--------|---------|----------|
| Strandspeed (m/min) ^① | 6 - 40 | 11 - 70 | 20 - 80 |
| max. No. of strands ^② | 8 | 8 | 8 |
| Power (kW) | 1,1 | 1,5 | 1,5 |
| Type of drive | Gear | Gear | Inverter |

| Product | Spec. Gravity (g/cm ³) | Throughput kg/h | | |
|---|------------------------------------|--|-----|-----|
| | | Pellet dimensions (mm) dia 3 x 3 long, * dia 2,5 x 2,5 long | | |
| PP,PE | 0,90 | 125 | 170 | 190 |
| PA 11,P 12 | 1,00 | 135 | 180 | 205 |
| PMMA, GPPS, SAN, ASA | 1,05 | 150 | 260 | 295 |
| HIPS, ABS | 1,05 | 135 | 180 | 205 |
| PA6 n.e* | 1,10 | 100 | 135 | 150 |
| PUR | 1,10 | 150 | 205 | 230 |
| PA6.6 | 1,15 | 130 | 175 | 200 |
| PET, PBT, PC | 1,20 | 130 | 175 | 200 |
| PET, PBT, PC, PA6.6, PA6 + 15 - 50% GF | 1,30 | 125 | 170 | 190 |



Strandpelletizer SGS 100-E

| | | | |
|----------------------------------|---------|----------|----------|
| Strandspeed (m/min) ^① | 13 - 65 | 20 - 80 | 20 - 80 |
| max. No. of strands ^② | 20 | 20 | 23 |
| Power (kW) | 4 | 4 | 5,5 |
| Type of drive | Gear | Inverter | Inverter |

| Product | Spec. Gravity (g/cm ³) | Throughput kg/h | | |
|---|------------------------------------|--|-----|-----|
| | | Pellet dimensions (mm) dia 3 x 3 long, * dia 2,5 x 2,5 long | | |
| PP,PE | 0,90 | 460 | 510 | 710 |
| PA 11,P 12 | 1,00 | 500 | 580 | 800 |
| PMMA, GPPS, SAN, ASA | 1,05 | 525 | 600 | 825 |
| HIPS, ABS | 1,05 | 470 | 540 | 740 |
| PA6 n.e* | 1,10 | 400 | 435 | 600 |
| PUR | 1,10 | 535 | 610 | 840 |
| PA6.6 | 1,15 | 480 | 550 | 760 |
| PET, PBT, PC | 1,20 | 480 | 550 | 760 |
| PET, PBT, PC, PA6.6, PA6 + 15 - 50% GF | 1,30 | 440 | 510 | 700 |



Stranggranulator SGS 200-E

| | |
|----------------------------------|----------|
| Strandspeed (m/min) ^① | 20 - 80 |
| max. No. of strands ^② | 40 |
| Power (kW) | 7,5 |
| Type of drive | Inverter |

| Product | Spec. Gravity (g/cm ³) | Throughput kg/h |
|---|------------------------------------|--|
| | | Pellet dimensions (mm) dia 3 x 3 long, * dia 2,5 x 2,5 long |
| PP,PE | 0,90 | 1350 |
| PA 11,P 12 | 1,00 | 1450 |
| PMMA, GPPS, SAN, ASA | 1,05 | 1600 |
| HIPS, ABS | 1,05 | 1350 |
| PA6 n.e* | 1,10 | 1100 |
| PUR | 1,10 | 1350 |
| PA6.6 | 1,15 | 1200 |
| PET, PBT, PC | 1,20 | 1200 |
| PET, PBT, PC, PA6.6, PA6 + 15 - 50% GF | 1,30 | 1050 |

^① Different strand speeds upon request

^② Strand dia 3 mm

